



## RH Convex Power Camper *Signal*® Mirror Replacement Sheet

### Note: Professional Installation Recommended

Warranty does not cover damage to the vehicle or mirror housing due to improper installation. The following installation instructions are to be considered as a guide only. Door removal procedures, indicator wire color and location may have changed since publication of these instructions. The installer is responsible for any damage that may occur during installation.

**PLEASE READ INSTRUCTIONS PRIOR TO INSTALLATION.**

### INCLUDED ITEMS:

- 1 RH Convex *Signal*® mirror
- 1 Replacement instruction sheet

### REQUIRED TOOLS:

- Large slotted screwdriver
- Small slotted screwdriver
- Large Phillips screwdriver
- Small Phillips screwdriver
- Small pry bar
- Sturdy gloves
- Safety glasses or goggles



### PROBLEMS OR QUESTIONS?

Technical Assistance is available by calling  
Muth Mirror Systems Technicians at:

1-800-844-6616

Monday through Friday  
Between 8:00 a.m. and 5:00 p.m. CST

Or through the Muth web site: [www.muthco.com](http://www.muthco.com)

Or via E-mail: [techsupport@muthco.com](mailto:techsupport@muthco.com)

# ***THE safety accessory of the 21<sup>st</sup> Century.™***

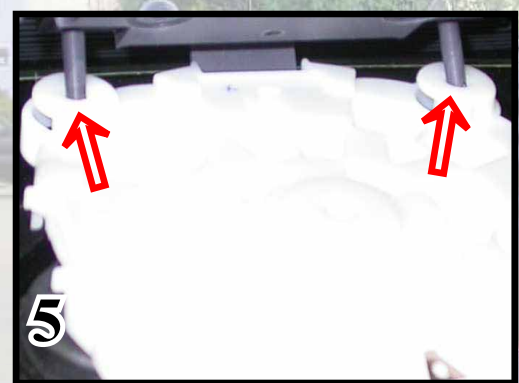
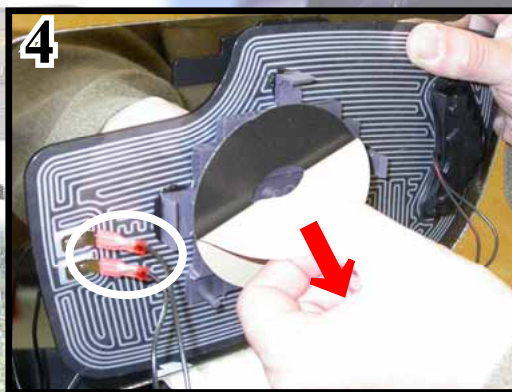
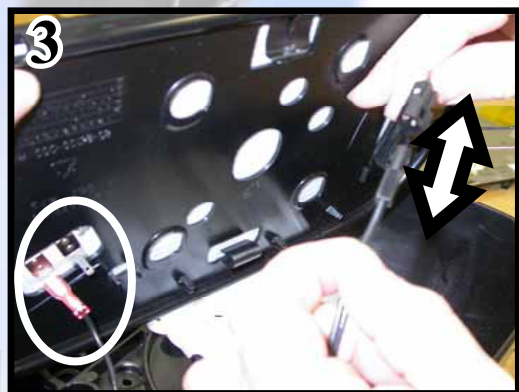
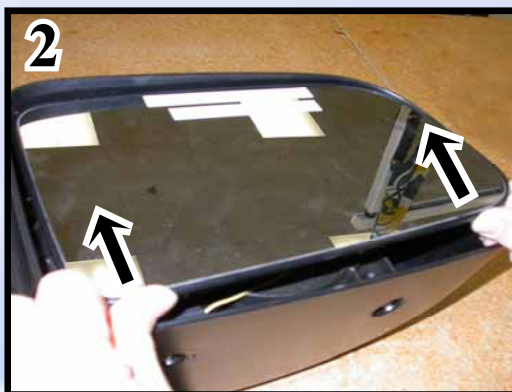

## Mirror Replacement

**WARNING! Safety glasses and sturdy gloves are recommended for mirror glass replacement.**

1. **NOTE: Removal of the mirror housing from vehicle is NOT necessary for glass replacement.** Push on the top edge of the mirror to manually pivot it fully outward. Insert a large flathead screwdriver into groove and push-up on locking tab.
2. While continuing to apply upward pressure to locking tab, push backplate up toward the top of mirror housing to unlock backplate from motor actuator.
3. Lift up backplate and disconnect heater connections if heated. Disconnect *Signal®* mirror harness connection. Remove OE mirror from mirror housing.
4. Make the connection between the wire harness and the new *Signal®* mirror. Connect the heater connectors to the heater terminals on the new *Signal®* mirror. **NOTE: There is no polarity so the wires may be interchanged.** Tuck wire harness(es) neatly behind motor actuator. Remove the double-sided adhesive disc liner.
5. Align the motor mount posts to their corresponding holes on the motor actuator. Slowly seat the new *Signal®* mirror into place.
6. With the entire palm of your hand, firmly press down on the *Signal®* mirror until it snaps into place. Press down on all sides of the *Signal®* mirror to ensure proper fit, form, and function.

**WARNING: Verify to make sure all snaps on the motor mount snap securely onto the motor actuator. Not doing so could result in mirror falling off due to improper installation.**

**Muth products are protected by these, and other pending, United States Patents**

6,749,325	6,700,123	6,257,746	D430,088	D429,202	D428,842	D428,373	D428,372	D427,128	6,076,948	D426,507	D426,506
D425,466	6,045,243	6,005,724	D409,540	5,788,357	D394,833	5,619,375	5,619,374	5,528,422	5,481,409	D363,920	5,361,190
5,355,284	5,207,492	5,128,659	5,014,167	5,005,009	7,008,091	7,015,642	3,075,779				