

Wiring:

Wire Routing

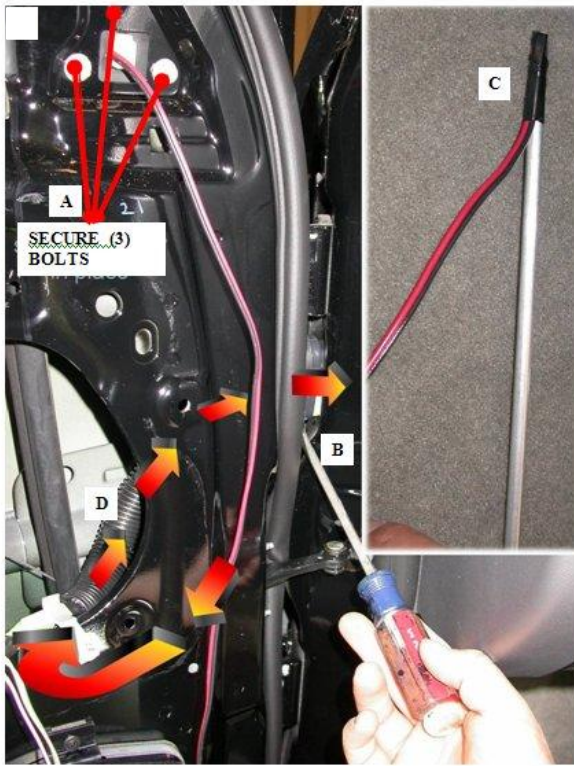

Guide the wire harness through the door and position the mirror housing assembly on the mirror mount. Attach the mirror housing to the mirror mount with three mirror mounting bolts (A). **WARNING!** Do not over tighten the mirror mounting bolts.

Pull back a portion of the plastic door frame insulation to gain access to rubber boot inside door frame.

Using a flat screwdriver, push-down from the top and push-up from the bottom to release rubber boot connector from the vehicle frame (B). Pry out the rubber boot connector.

Tape the open end of the Signal[®] mirror wire harness to the gopher rod (C).

Push the gopher rod from inside door frame through the rubber boot (D). Once the gopher rod with the Signal[®] mirror wire harness protrudes through the rubber boot, cut the tape with a utility knife and pull the Signal[®] mirror wire harness through rubber boot, removing any slack in the Signal[®] mirror wire harness.

To get the wire inside the vehicle, insert the Signal[®] mirror wire harness into the hole vacated by the rubber boot connector. Remove any slack in the Signal[®] mirror wire harness. Snap the rubber boot connector back onto the vehicle frame.

The Signal[®] mirror wire harness for the driver side mirror needs to run under the dashboard to the passenger side kick panel.

WARNING: When routing wire into vehicle, it is extremely important to not let wire get pinched or crushed at any time. Avoid window track and sharp edges at all times. Not doing so may cause circuit shortage problems down the road.

Wire Identification

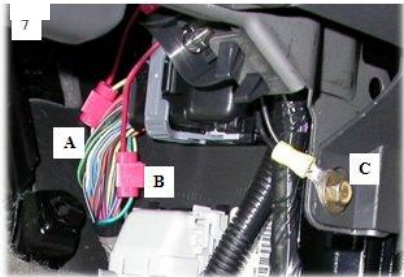
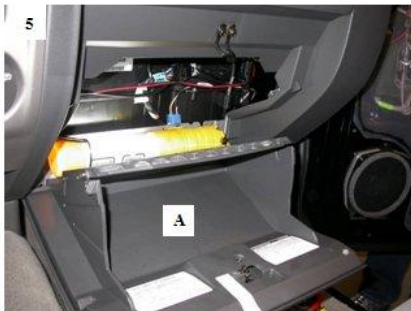

Repeat all of the previous steps to replace the factory mirror on the passenger side door with the new Signal[®] mirror. To gain access to the hole vacated by the rubber boot connector on the passenger side, you may need to fully open the glove box as shown (A).

6. The vehicle's electrical wiring is located within the wire bundle on the passenger side kick panel. Locate the solid YELLOW wire within the wire bundle. Turn the ignition key so that electrical power is on and activate the driver side turn indicator. Probe the wire with the wire tester to verify that flashing turn directional power is present. Label that wire as 'driver side indicator'. Locate the GREEN wire and activate the passenger side turn indicator. Probe the wire with the wire tester to verify that flashing turn directional power is present. Label that wire as 'passenger side indicator'.

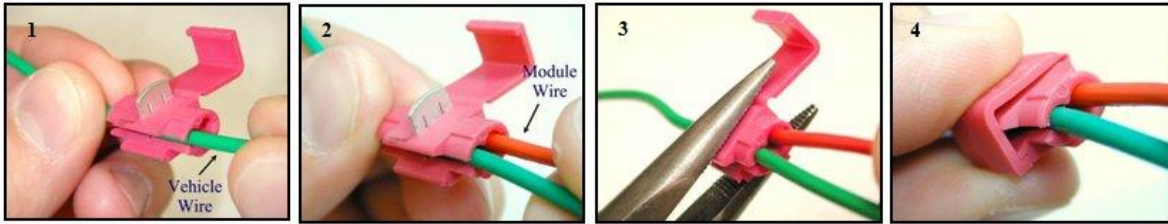

USE THE INCLUDED WIRE TAPS AND FOLLOW THE FOUR STEPS ABOVE TO SPLICE INTO THE TURN INDICATOR WIRES

37. Make sure the harnesses are routed securely under the dash and enough slack is left for splicing.
38. Splice the BLACK w/ RED TRACE wire from the driver side harness into the solid YELLOW wire previously labeled 'driver side indicator' (7A).
39. Splice the BLACK w/ RED TRACE wire from the passenger side harness into the GREEN wire previously labeled 'passenger side indicator' (7B).
40. Strip and twist together the ends of the black wires from each harness. Crimp them together in the supplied ring connector and ground to a suitable nearby location on the metal framework of the vehicle (7C).
41. Activate each turn indicator to verify that the *Signal* mirrors are working properly.
42. Reconnect all original wiring. Turn the ignition power to on, check to verify all features are working properly.
43. Replace the plastic door frame moldings, trim, door panels, and all accessories.

Door Panel:

Door Panel & Mirror Housing Removal

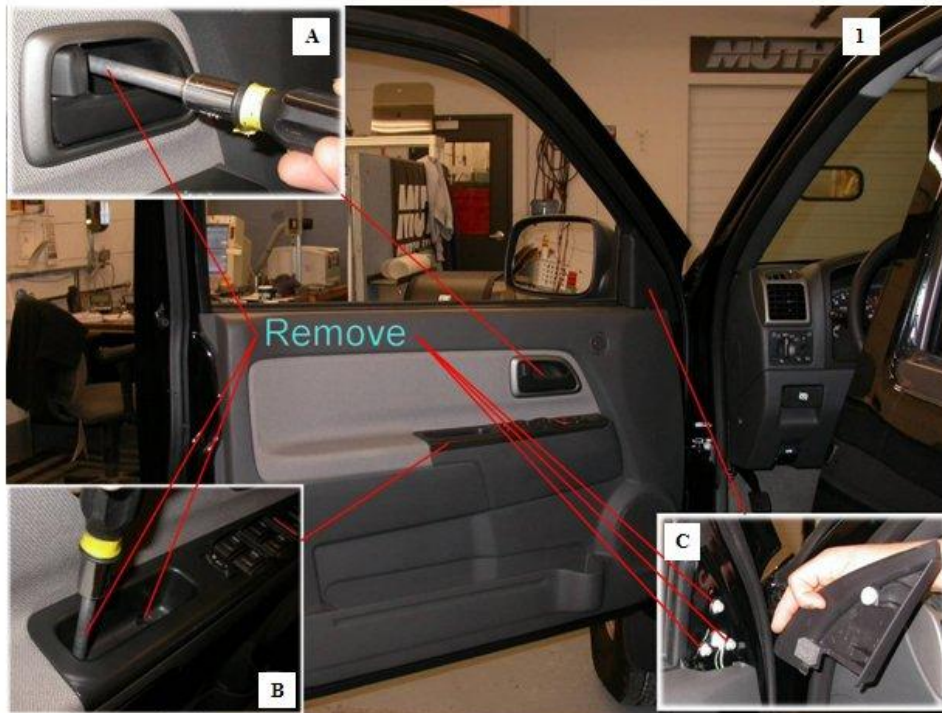

1. Start with opening the driver's side door and lowering the window. Remove screw in door handle (A) and remove door handle cover. Remove the (2) screws located at the control console (B). Lift up, disconnect all wiring connectors and remove control console. Unsnap corner plastic triangular cover (C). Secure the mirror housing with one hand, remove the (3) bolts holding the mirror housing to the door frame using a 10mm socket. Carefully remove mirror housing from door frame and set mirror housing on a cloth covered surface. Pull on door panel to unsnap it from door. Lift up and hold door panel a few inches away. Disconnect tweeter and remove door panel.