

Wiring:

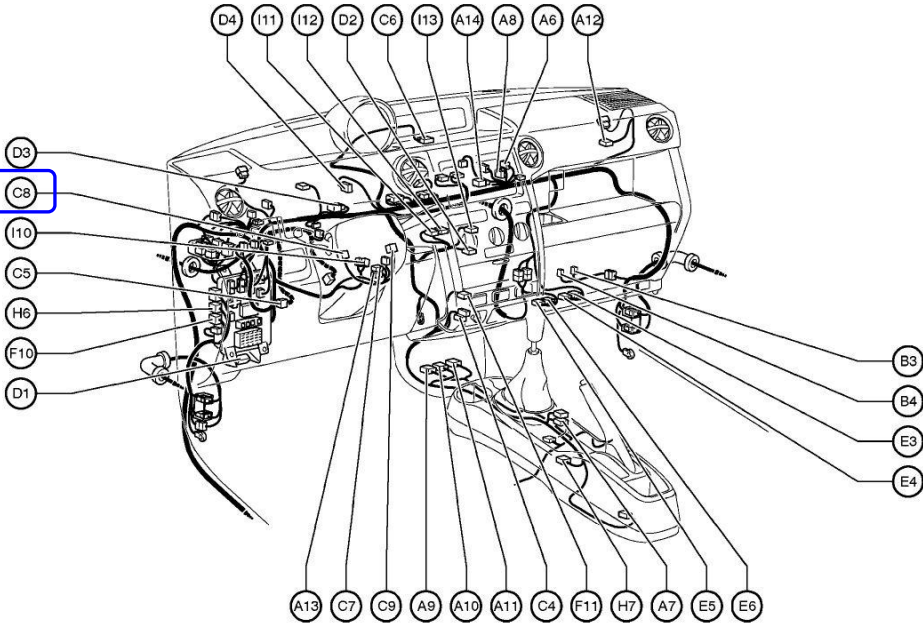

- C 4 Cigarette Lighter
- C 5 Clutch Start SW
- C 6 Combination Meter
- C 7 Combination SW
- C 8 Combination SW**
- C 9 Combination SW

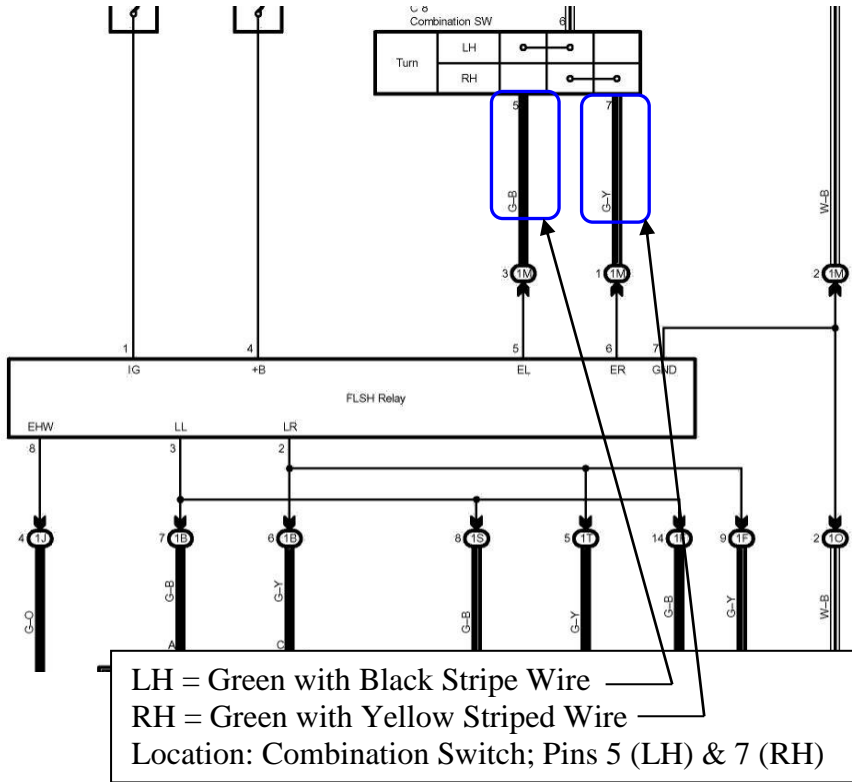
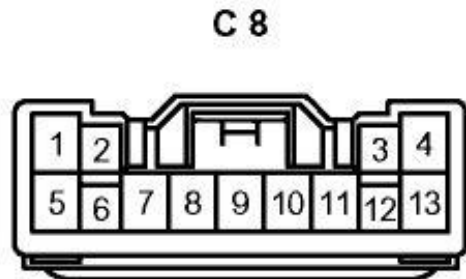

## Door Panel:

**HINT:**

- Use the same procedure for the RH side and LH side.
- The procedures listed below are for the LH side.

1. DISCONNECT CABLE FROM NEGATIVE BATTERY TERMINAL.

**CAUTION:** Wait at least 90 seconds after disconnecting the cable from the negative (-) battery terminal to prevent airbag and seat belt pretensioner activation.

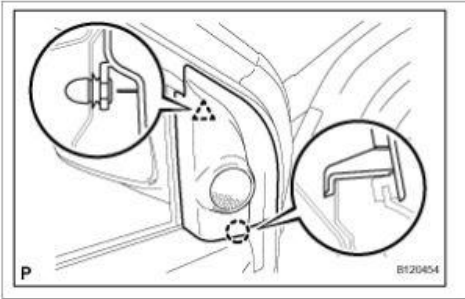

2. REMOVE FRONT DOOR LOWER FRAME BRACKET GARNISH LH

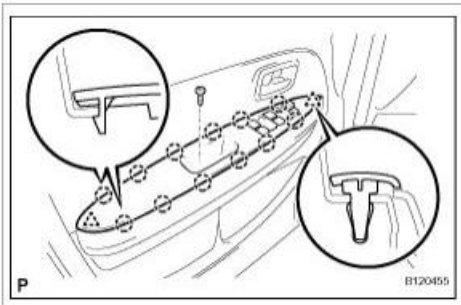

(a) Using a screwdriver, detach the clip and claw, and remove the garnish.

**HINT:** Tape the screwdriver tip before use.

3. REMOVE FRONT ARMREST BASE PANEL UPPER LH

(a) Remove the screw.

(b) Using a screwdriver, detach the 12 claws and 2 clips, and remove the armrest base panel together with the switch.

**HINT:** Tape the screwdriver tip before use.

(c) Disconnect the switch connector.

Door Panel:

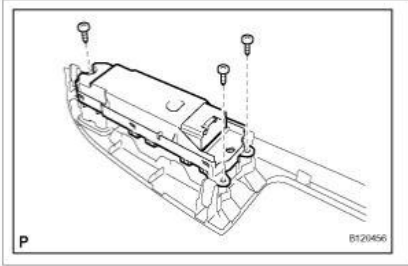

(d) Driver side: Remove the 3 screws and switch from the armrest base panel upper.

**NOTICE:** Be careful when removing the screw as the master switch may fall and become damaged.

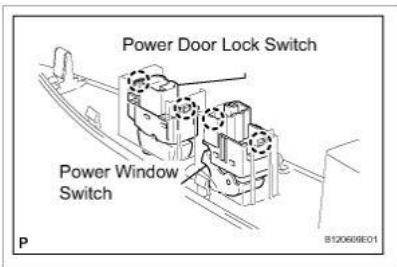

(e) Passenger side:

- (1) Detach the 2 claws and power window switch from the armrest base panel upper.
- (2) Detach the 2 claws and door lock switch from the armrest base panel upper.

4. REMOVE FRONT DOOR TRIM BOARD SUBASSEMBLY LH

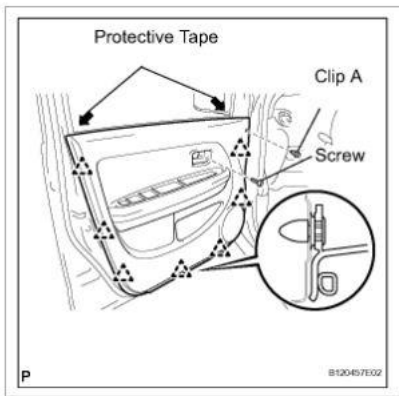

- (a) Remove the screw and clip A as shown in the illustration.
- (b) Using a clip remover, detach the 7 clips.
- (c) Remove the trim board upward.

**HINT:** In order to prevent the door panel from being damaged, use protective tape to cover the areas indicated by the arrow marks in the illustration.

(d) Using a screwdriver, detach the claws and remove the weatherstrip inner.

**HINT:** Tape the screwdriver tip before use.

5. REMOVE FRONT DOOR INSIDE HANDLE SUBASSEMBLY LH

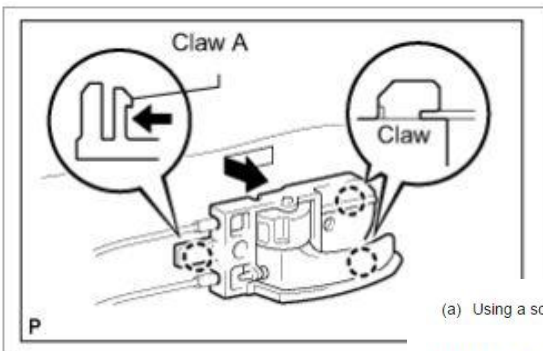

(a) Using a screwdriver, detach claw A.

**HINT:** Tape the screwdriver tip before use.

(b) Move the inside handle in the direction indicated by the arrow mark in the illustration. This will release the 2 claws and allow removal of the inside handle.

(c) Disconnect the 2 cables from the inside handle.